

# DC User Guide

ED900 A + CP + IS + D

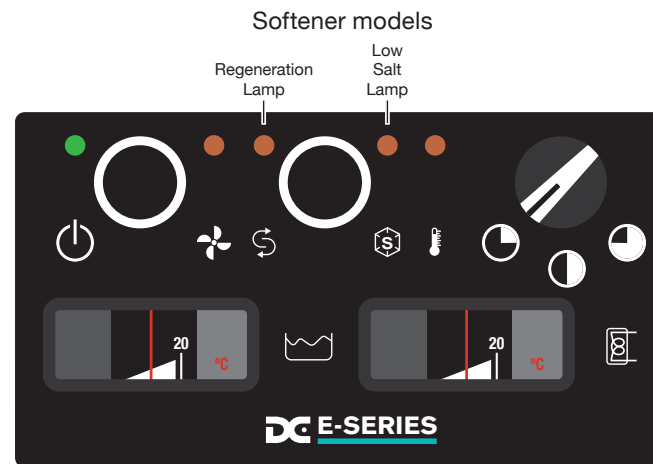
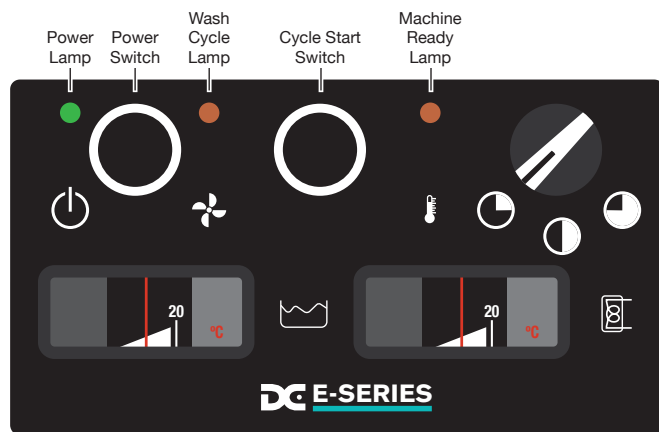

## Models with integral water softeners

**1** The **Low Salt** light turns on when salt is low or empty.

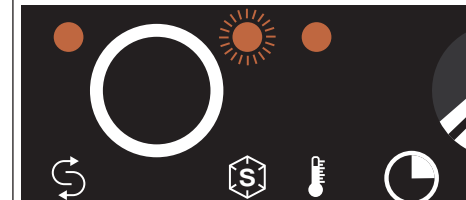

**2** To top up salt, ensure machine is empty of water. Open **Hood**, unscrew **Salt Container Lid** and fill with granular catering salt only.



**3** Screw **Lid** back on **Salt Container** and close **Hood**. **Low Salt** light will turn off after a few minutes.

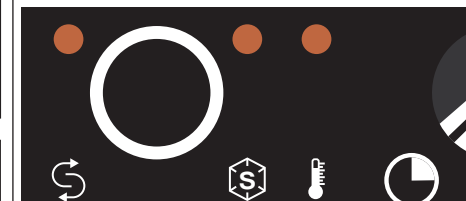

### WARNING

**Do not spill salt** - if salt is spilt onto stainless steel it can damage it. Rinse thoroughly with water. Ensure **Salt Container Lid** is secure after filling.

## Preparation

**1** Make sure **Water Supply** and **Mains Electrics** are switched on.

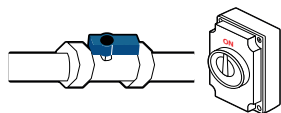

**2** Firmly push **Drain Plug** in and ensure all **Filters** are in position.

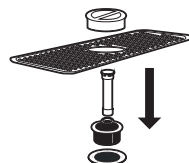

**3** Check **Chemical Tubes** and replace container if chemicals are low.

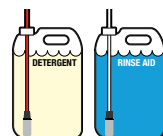

**4** Close **Hood** and press the **Power Button**. The green **Power Light** turns on.



**5** When machine fills and reaches wash temperature, the **Ready Light** turns on.



## Operation

**1** Remove debris and pre-rinse items before loading **Basket**, ensuring no items are covering each other.

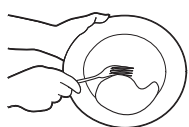

**2** Load items into basket, then push **Basket** into machine.

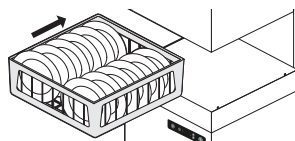

**3** Close **Hood**. **Wash Cycle** starts automatically and **Wash Cycle** light turns on.



**4** At end of cycle the **Wash Cycle** light turns off.



**5** Open **Hood** and remove **Basket**. **TIP:** Allow excess water to run off before removing.

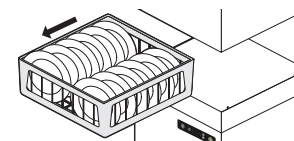

## Good washing guide

- Anything remaining on items must be removed before washing.
- Should items be prewashed with soaps or washing up liquids, items must be rinsed before placing inside machine. Washing up liquids should not enter the machine, as they can cause excessive foaming,
- which reduces washing performance and prevents draining.
- Excessive foaming can damage the machine.
- The use of washing up liquids and soaps can cause flooding and damage the machine.
- Don't interrupt wash cycle.
- Ensure machine has reached correct temperature before washing.
- Don't put items not suited to a passthrough in machine - only wash items designed to be washed in a passthrough.

## Daily cleaning and maintenance

**1** At the end of service, press **Power Switch**. Do not remove any filters at this stage.



**2** Remove **Basket Track** to allow easy access for filter removal and cleaning.

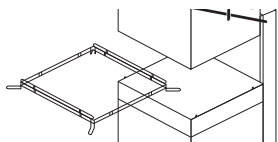

**3** Wipe debris from the upper wash tank and **Filter Surface** into the **Upper Filter Bowl**.

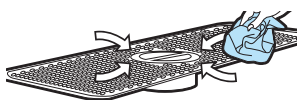

**4** Remove **Upper Filter Bowl**, empty debris and clean with an 'Addis' type washing up brush.



**5** Remove **Filter Surface** and clean thoroughly. Remove **Drain Plug**, wash tank will empty.



\* Passthroughs fitted with a drain pump will automatically start to pump water out.

**6** Collect debris from bottom wash tank into **Lower Filter**.



**7** Remove and clean **Filters** thoroughly with an 'Addis' type washing up brush.



**9** Fibers and food debris can be cleaned easily from the surfaces and filter holes by brushing.



**10** Do not hit **Filters** against anything to prevent damage or distortion.



**11** Be careful not to allow debris to go down into **Lower Sump** as this may damage passthrough.



**12** Replace **Lower Filter, Filter Surface, Upper Filter Bowl** and **Drain Plug** after cleaning.

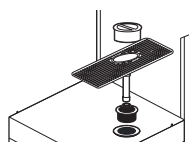

**13** Replace **Basket Track** before use.

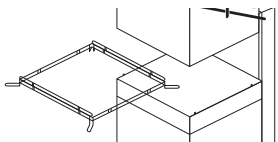

**14** Regularly check **Rinse Jets** and **Wash Jets** are clear of debris or limescale.\*

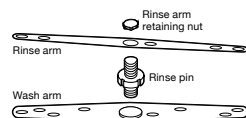

**15** Cutlery, plastic wrappers and broken items should be removed from inside **Wash Tank**.

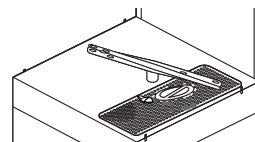

\* Remove if necessary by unscrewing the **Rinse Arm Retaining Nut** that holds the **Rinse Arm** in place. Remove the **Rinse Pin** that holds the **Wash Arm** in place - clean both arms thoroughly and reassemble.

## Emptying the machine

**1** To drain water from passthrough, open **Hood** and remove **Filter Surface** and **Upper Filter Bowl**. Remove debris from filters, being careful not to spill any in passthrough. Remove **Drain Plug** and then press **Power Off** button.

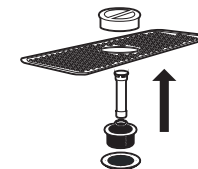

**2** The passthrough will drain until wash tank empties and then switches off.

## Cleaning chemicals

### Warning

Do not use any chemical compounds in or around the machine containing chlorine ions (bleach, chlorine, salt etc) either undiluted or in diluted solutions such as detan, brine, Milton bleach etc. They are incredibly corrosive to stainless steel A304 and can quickly cause the appearance of stains and pin holes in the stainless steel, allowing rust to occur.

If chemicals containing chlorine ions are put into the machine, ensure that all debris is removed and the machine thoroughly rinsed to ensure no corrosive chemicals remain.

Do not use steel wool scouring pads to clean the inside or outside of the machine.

### Please note

Any corrosion of this sort that occurs is due to misuse and it is not covered under warranty.

Correct PPE should be worn at all times when operating or carrying out maintenance..

## Chemical filters

### Detergent chemical

The **Red Tube** to the machine is used for detergent.

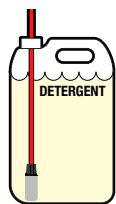

### Rinse aid chemical

The **Clear or Blue Tube** to the machine is used for the rinse aid chemical.



The amount of detergent or rinse aid dosed depends on the quality and dilution information provided on the detergent chemical container. You may need to adjust the dosing quantity if you change the supplier of the chemical product. Please see the dosing guide for more information.

**Incorrect dosing quantities will always give poor washing results.**

## Filters

Filters provide protection for the passthrough's internal pumps and collect food, debris while washing.

**Don't use the machine without the filters in position.**

